



DATA SHEET

Follow Me

Landing LED Light

General information

Follow Me is **LED landing light** (white) which covers all the required spectrum - the terrain and runway ahead during takeoff and landing procedure. It is designed for LSA, Ultralight, KIT and Experimental aircraft.

Follow Me landing light is very compact and efficient, always ensuring you to have extremely clear visibility. Anodized aluminium encapsulation ensures that the lamp is water and vibration resistant.

Technical Data

Operation voltage range	11,0 V – 28,0 V
Dimensions	71mm x 61mm + bracket
Weight	330 g
Operation temperature range	- 20°C to + 80°C
Current	2,8 (13,5 VDC) - 1,4 (27VDC)
Input power	38 W
Light angle (2 lamps)	12° narrow range (per each)
Light angle (1 lamp)	30° wide range
Light luminosity	8000 lm
Converter	Built in
Glass type	Plexiglas (6mm, lens system)
Wiring requirement	1 mm ² cable
Encapsulation	Anodized aluminium
Reverse polarity protection	YES
Vibration resistance	YES
Water resistance	YES (IP54)
Warranty	2 years

Drawing

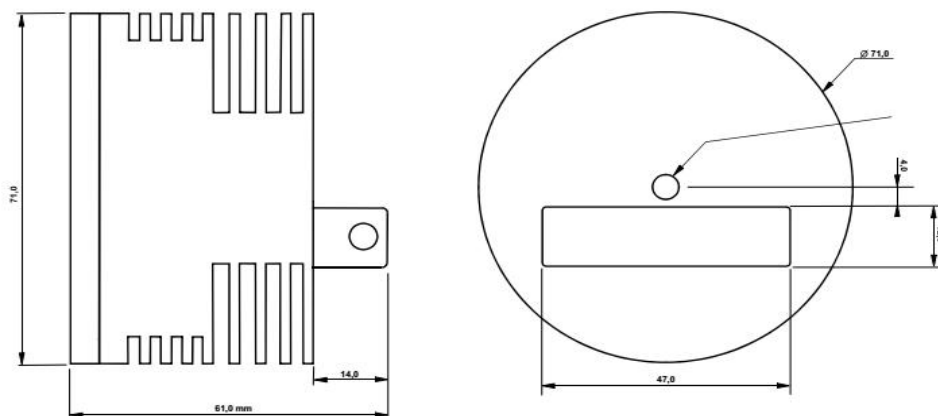

Wiring diagram

